



7 Valor Drive, Aylesbury, Buckinghamshire, HP18 0WL

**£385,000**

- Chain Free
- Berryfields development
- Conservatory
- South facing rear garden
- 5 Min walk to train station
- Utility room

## THE PROPERTY

Offered to the market chain free, this three bedroom family home is located within the sought after Berryfields development in Aylesbury.

Providing approximately 1,250 sq ft of well balanced accommodation, this property is ideal for families, professional couples or buyers looking for a move in ready home in Berryfields, Aylesbury.

The ground floor features a bright entrance hall, spacious living room and a kitchen dining room with excellent storage and preparation space. Double doors open into a light filled conservatory overlooking the rear garden, creating valuable additional living space perfect for entertaining, working from home or relaxing.

A separate utility room and ground floor cloakroom add further practicality.

Upstairs offers three well proportioned bedrooms. The principal bedroom benefits from fitted storage and a private ensuite shower room. Bedroom two is a generous double, while bedroom three is ideal as a nursery, guest bedroom or home office. A family bathroom completes the first floor.

Externally, the property enjoys a private south facing rear garden, ideal for enjoying sunshine throughout the day and perfect for outdoor dining. To the front there is driveway parking, providing excellent off road parking.

Situated within the popular Berryfields area, close to local schools, Aylesbury Vale Parkway station, shops and amenities, this chain free three bedroom house for sale in Aylesbury presents an excellent opportunity.

Early viewing is highly recommended. Contact 360 Properties Aylesbury to arrange your appointment.

Freehold

## SITUATION

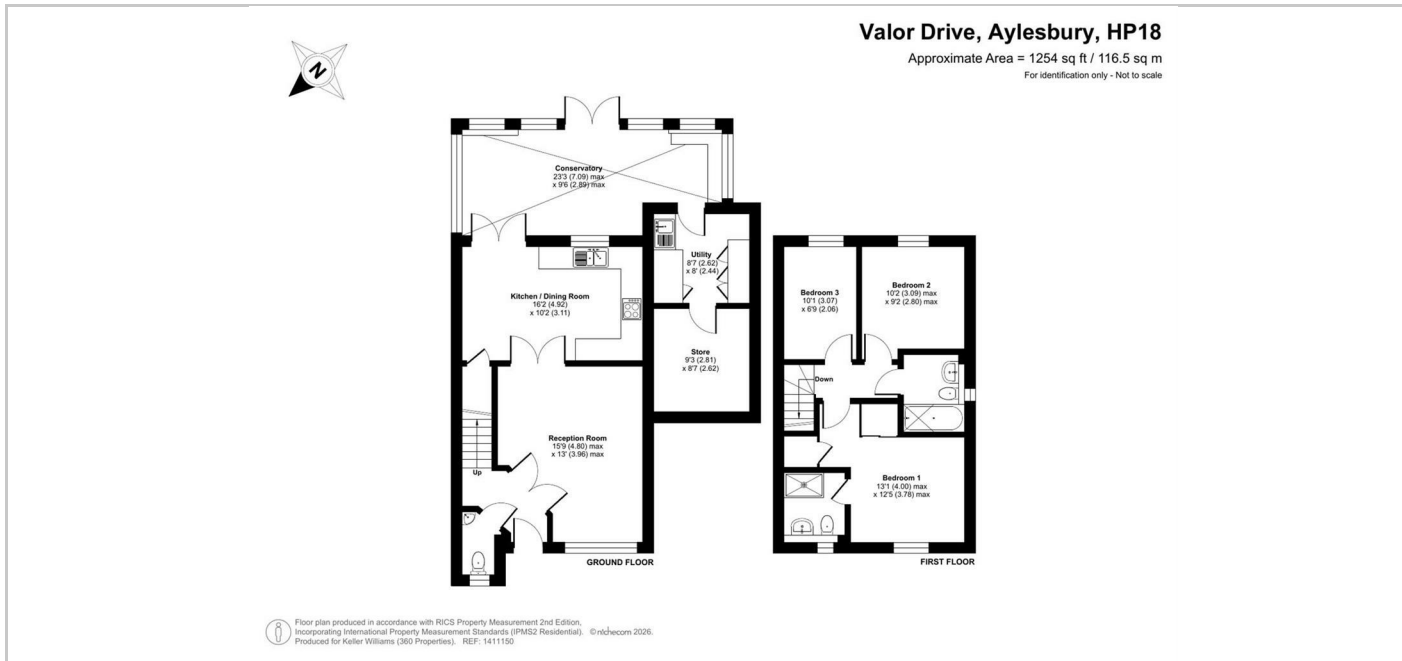

## Directions

Market House Market Sq, Aylesbury, HP1201TN

Tel: 01296 767555 Email: [francis@360-properties.co.uk](mailto:francis@360-properties.co.uk) <https://www.360-properties.co.uk>